

TOROIDAL CORE



● Ordering Code

K5A T 6 X 3 X 3
(1) (2) (3) (4) (5)

(1) Material (4) C Size
(2) Type Code (5) D Size
(3) A Size

● Shapes

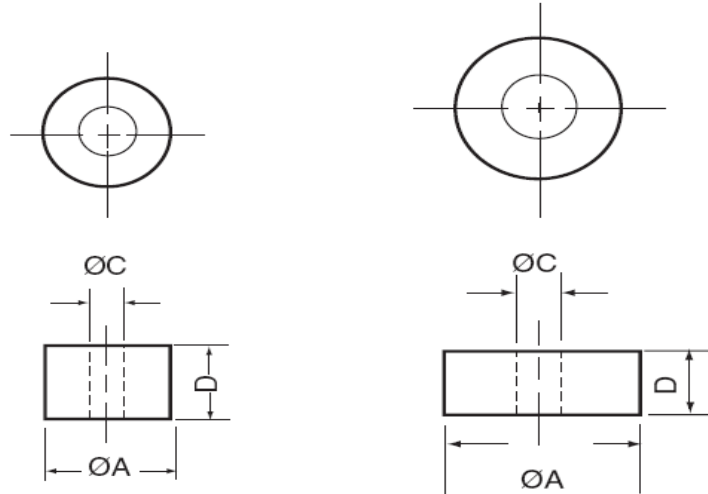
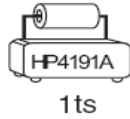

TOROIDAL CORE

● Dimensions & Characteristics

Unit : mm

NO	ITEM	ØA	ØC	D	Impedance (Ω) min.		AL(nH)
					25MHz	100MHz	
1	K5A T 3.2 X 1.25 X 3	3.2±0.15	1.25±0.1	3±0.2			368
2	K6 T 4 X 2 X 3	4±0.2	2±0.15	3±0.2		16	600
3	K6 T 4.1 X 2 X 3	4.1±0.2	2±0.15	3±0.2		15	620
4	K5A T 4.5 X 1.5 X 3.5	4.5±0.2	1.5±0.15	3.5±0.2	70	100	490
5	K6 T 4.8 X 2.8 X 1.5	4.8±0.2	2.8±0.2	1.5±0.2			12 min
6	K6 T 5 X 1.5 X 4	5±0.2	1.5±0.15	4±0.3			1292
7	K5A T 5 X 3 X 2	5±0.2	3±0.2	2±0.2			140
8	K5A T 5.08 X 2.36 X 4.8	5.08±0.2	2.36±0.15	4.8±0.3	310	490	491
9	K5A T 6 X 1.8 X 3	6±0.2	1.8±0.15	3±0.2			453
10	K6 T 6 X 3 X 2	6±0.2	3±0.2	2±0.2			400
11	K6 T 6 X 3 X 3	6±0.2	3±0.2	3±0.2			10
12	K5A T 7 X 3.5 X 4	7±0.2	3.5±0.2	4±0.3	15	45	373
13	K6 T 7.62 X 3.18 X 4.78	7.62±0.2	3.18±0.2	4.78±0.3	25	50	1179
14	K6 T 8 X 4 X 4	8±0.2	4±0.2	4±0.3			800
15	K6 T 9 X 5 X 3	9±0.3	5±0.25	3±0.2	15	45	514
16	K5 T 9.15 X 5.02 X 4.7	9.15±0.3	5.02±0.25	4.7±0.3		35	548
17	P3 T 9.35 X 4.75 X 3.2	9.35±0.3	4.75±0.25	3.2±0.2		50	43
18	K5A T 9.5 X 4.75 X 4.8	9.5±0.3	4.75±0.2	4.8±0.3		30	448
19	K5A T 9.5 X 4.79 X 5	9.5±0.3	4.79±0.2	5±0.3			461
20	K5A T 9.5 X 5 X 5	9.5±0.3	5±0.3	5±0.3	20	35	434
21	K5A T 9.5 X 5.02 X 5	9.5±0.3	5.02±0.3	5±0.3	20	35	432
22	K5A T 9.53 X 5.02 X 4.8	9.53±0.3	5.02±0.25	4.8±0.3		30	595
23	K5A T 9.58 X 6.4 X 5	9.58±0.3	6.4±0.3	5±0.3			279
24	K5A T 9.65 X 5 X 5.05	9.65±0.3	5±0.25	5.05±0.3	21	43	449
25	K6 T 9.65 X 5.02 X 4.83	9.65±0.3	5.02±0.25	4.83±0.2	10	30	
26	K5A T 10 X 5 X 5	10±0.3	5±0.25	5±0.3	25	55	467
27	P1B T 10 X 5.1 X 9	10±0.3	5.1±0.25	9±0.3	30	60	643
28	K6 T 10 X 6 X 4	10±0.3	6±0.3	4±0.3			600
29	K5A T 10 X 7 X 5	10±0.3	7±0.3	5±0.3	15	40	247
30	K6 T 12 X 6 X 6	12±0.3	6±0.3	6±0.3			
31	K5A T 12 X 7 X 5.5	12±0.3	7±0.3	5.5±0.3	15	40	405
32	K5A T 12.7 X 7.9 X 6.35	12.7±0.3	7.9±0.3	6.35±0.3	21	42	414
33	K5A T 13 X 7 X 3	13±0.3	7±0.3	3±0.2	15	30	252
34	K6 T 13 X 7.3 X 12.7	13±0.3	7.3±0.3	12.7±0.4			
35	K5A T 13 X 8 X 12.7	13±0.3	8±0.3	12.7±0.3		30	847
36	K5A T 14 X 8.7 X 7	14±0.4	8.7±0.3	7±0.3	25	45	458
37	K5A T 14 X 10 X 5.5	14±0.4	10±0.3	5.5±0.3	12	40	
38	K5A T 14.2 X 4.5 X 6	14.2±0.4	4.5±0.4	6±0.3	35	85	1245
39	K5A T 14.2 X 6.35 X 13.8	14.2±0.4	6.35±0.3	13.8±0.4	60	100	1476
40	K5A T 14.5 X 10.5 X 8	14.5±0.4	10.5±0.4	8±0.3	15	45	358
41	K5A T 15.7 X 10 X 4.3	15.7±0.4	10±0.4	4.3±0.3	15	35	267
42	K5A T 15.9 X 7.9 X 14.3	15.9±0.4	7.9±0.3	14.3±0.4	60	100	1346

Changshu TianYin Non-Ferrous Metals Co., Ltd.

TOROIDAL CORE

● Dimensions & Characteristics

Unit : mm

NO	ITEM	ØA	ØC	D	Impedance (Ω) min.		AL(nH)
					25MHz	100MHz	
43	K5A T 16 X 8 X 13	16±0.4	8±0.3	13±0.4	45	90	1213
44	K5A T 16 X 10 X 5	16±0.4	10±0.4	5±0.3			323
45	K6 T 16 X 12 X 8	16±0.4	12±0.4	8±0.3	20	30	686
46	K5A T 16.5 X 8.2 X 13	16.5±0.4	8.2±0.3	13±0.4	45	100	1223
47	K5A T 17.4 X 9.6 X 15	17.4±0.4	9.6±0.3	15±0.4			1213
48	K5A T 17.5 X 9.5 X 12.7	17.5±0.4	9.5±0.3	12.7±0.4	45	70	1054
49	C8 T 18 X 7 X 3	18±0.5	7±0.3	3±0.2			106
50	K5A T 18.3 X 10 X 10	18.3±0.5	10±0.4	10±0.4	30	80	
51	K5A T 18.4 X 9.5 X 15	18.4±0.5	9.5±0.3	15±0.4	50	85	1340
52	K5A T 18.4 X 9.6 X 12	18.4±0.5	9.6±0.3	12±0.4	45	80	1056
53	K5A T 18.7 X 10.2 X 17	18.7±0.5	10.2±0.4	17±0.4	45	80	1400
54	K5A T 20 X 10 X 10	20±0.6	10±0.4	10±0.4	40	75	933
55	K5A T 20.7 X 12 X 14	20.7±0.6	12±0.4	14±0.4	140	250	980
56	K5A T 21 X 13.2 X 12	21±0.6	13.2±0.4	12±0.4	30	65	776
57	K5A T 21 X 15 X 12	21±0.6	15±0.5	12±0.4	25	50	
58	K5A T 22 X 13.5 X 8	22±0.6	13.5±0.4	8±0.3	30	60	536
59	K5A T 22 X 14 X 8	22±0.6	14±0.4	8±0.3	30	60	498
60	K5A T 22.5 X 13.8 X 6.4	22.5±0.6	13.8±0.4	6.4±0.3	15	45	
61	K5A T 22.5 X 13.8 X 12.8	22.5±0.6	13.8±0.4	12.8±0.4	40	80	
62	K5A T 23 X 6.35 X 13.5	23±0.6	6.35±0.3	13.5±0.4			1809
63	K5A T 23 X 11 X 14	23±0.6	11±0.4	14±0.4	60	110	1384
64	K5A T 23 X 13.5 X 6.35	23±0.6	13.5±0.4	6.35±0.3	15	45	463
65	K5A T 23 X 13.8 X 5.5	23±0.6	13.8±0.4	5.5±0.3	17	34	
66	K6 T 23.5 X 12.6 X 9.4	23.5±0.6	12.6±0.4	9.4±0.3	60	120	1703
67	K5A T 24 X 11 X 14	24±0.6	11±0.4	14±0.4	45	85	1456
68	K5A T 24 X 14 X 11	24±0.6	14±0.4	11±0.4	35	63	
69	K5A T 25 X 15 X 8.1	25±0.6	15±0.4	8.1±0.3			
70	K5A T 25 X 15 X 12	25±0.6	15±0.6	12±0.4	35	80	467
71	K5A T 27 X 14.5 X 11	27±0.6	14.5±0.4	11±0.4	30	65	
72	K5A T 28 X 16 X 13	28±0.6	16±0.3	13±0.4	40	80	993
73	K5A T 29 X 19 X 7.5	29±0.6	19±0.5	7.5±0.3	20	50	438
74	K5A T 29 X 19 X 8.1	29±0.6	19±0.5	8.1±0.3			
75	K5A T 31 X 19 X 8	31±0.9	19±0.5	8±0.3	25	60	
76	K5A T 31.75 X 19.05 X 16	31.75±0.8	19.05±0.5	16±0.4	50	90	
77	K5A T 31.75 X 19.05 X 22.5	31.75±0.8	19.05±0.5	22.5±0.6	60	90	
78	K5A T 35.6 X 23 X 12.7	35.6±0.8	23±0.6	12.7±0.4	25	90	765
79	K5A T 35.6 X 25.4 X 7.5	35.6±0.8	25.4±0.6	7.5±0.2	25	90	351
80	K5A T 36 X 25 X 16	36±1	25±0.8	16±0.5	30	80	
81	K5A T 40.6 X 27 X 15	40.6±1	27±0.6	15±0.4	35	85	845
82	K5A T 40.6 X 27.5 X 15	40.6±1	27.5±0.6	15±0.4	35	85	808
83	K5A T 61.4 X 36 X 12.8	61.4±1	36±0.75	12.8±0.4	45	80	

Changshu TianYin Non-Ferrous Metals Co., Ltd.