

SLEEVE CORE



● Ordering Code

$\frac{K5A}{(1)} \frac{RH}{(2)} - \frac{11}{(3)} \times \frac{5}{(4)} \times \frac{25}{(5)}$

(1) Material

(4) C Size

(2) Type Code

(5) D Size

(3) A Size

● Shapes



1ts

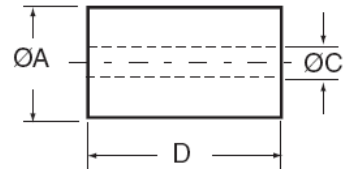
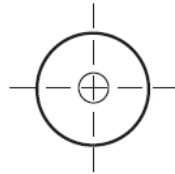

● Dimensions & Characteristics

Unit : mm

NO	ITEM	ØA	ØC	D	Impedance (Ω) min.	
					25MHz	100MHz
1	K5A RH 1.6X0.8X5(S)	1.6±0.15	0.8±0.1	5±0.3		33
2	K5A RH 2.45X1.3X2.5	2.45±0.15	1.3±0.1	2.5±0.2		
3	K5A RH 2.5X0.8X3	2.5±0.15	0.8±0.15	3±0.2	20	30
4	K5A RH 2.5X1X3	2.5±0.15	1±0.15	3±0.2	10	30
5	K5A RH 2.85X1.65x3.75	2.85±0.15	1.65±0.15	3.75±0.2	18/50MHz	
6	K5A RH 3X0.8X3	3±0.15	0.8±0.15	3±0.2		
7	K5A RH 3X1X3	3±0.15	1±0.15	3±0.2		
8	K5A RH 3X1.2X3.5	3±0.3	1.2±0.2	3.5±0.3	15	45
9	C8 RH 3.5X0.8X14	3.5±0.15	0.8±0.1	14±0.4		185
10	K5A RH 3.5X0.9X6	3.5±0.15	0.9±0.1	6±0.3	40	70

SLEEVE CORE

● Dimensions & Characteristics

Unit : mm

NO	ITEM	ØA	ØC	D	Impedance (Ω) min.	
					25MHz	100MHz
11	C8 RH 3.5X1X14	3.5±0.15	1±0.1	14±0.4		180
12	K5A RH 3.5X1.3X3	3.5±0.15	1.3±0.1	3±0.2	10	20
13	K5A RH 3.5X1.5X5	3.5±0.15	1.5±0.15	5±0.3	20	45
14	C3B RH 3.5X1.5X12	3.5±0.2	1.5±0.1	12±0.4	45	75
15	K5A RH 3.5X1.8X5.9	3.5±0.15	1.8±0.15	5.9±0.3		
16	K5A RH 3.5X2X4	3.5±0.2	2±0.2	4±0.3	10	25
17	K5A RH 3.5X2X6	3.5±0.2	2±0.2	6±0.3	15	30
18	K5A RH 3.8X0.8X8.3	3.8±0.15	0.8±0.1	8.3±0.3		100
19	K5A RH 3.9X1.3X5	3.9±0.15	1.3±0.1	5±0.3		
20	K5 RH 4X0.8X15	4±0.15	0.8±0.1	15±0.4		
21	K5A RH 4X1.5X5	4±0.2	1.5±0.15	5±0.3	20	35
22	K5 RH 4X2X15	4±0.2	2±0.15	15±0.4	50	80
23	K6 RH 4X2X25	4±0.2	2±0.15	25±0.3	90	120
24	K5A RH 4X2.2X6	4±0.2	2.2±0.15	6±0.3	20	40
25	K5A RH 4X2.2X25	4±0.2	2.2±0.15	25±0.6	90	120
26	K5A RH 4.1X0.8X6	4.1±0.2	0.8±0.1	6±0.3	90	
27	K5A RH 4.1X2X6	4.1±0.2	2±0.15	6±0.3	20	30
28	C3B RH 4.2X2X15(R)	4.2±0.2	2±0.15	15±0.4	45	90
29	C3B RH 4.2X2X15(C)	4.2±0.2	2±0.15	15±0.4	45	90
30	K5A RH 4.5X1.5X3.5	4.5±0.2	1.5±0.15	3.5±0.25	15	30
31	K5 RH 4.5X1.5X7	4.5±0.2	1.5±0.10	7±0.3	40	80
32	K5A RH 4.5X2.5X7	4.5±0.2	2.5±0.15	7±0.3	35	65
33	K5A RH 4.5X3X6	4.5±0.2	3±0.2	6±0.3		
34	K5A RH 4.7X2.75X25	4.7±0.2	2.75±0.15	25±0.6		
35	K5A RH 4.8X2.5X3.8	4.8±0.4	2.5±0.2	3.8±0.3	15	50
36	K6 RH 4.9X2X36	4.9±0.2	2±0.15	36±0.8	140	200
37	K5A RH 5X1X10	5±0.2	1±0.15	10±0.4	35	55
38	K5A RH 5X2.15X18	5±0.2	2.15±0.15	18±0.5	80	120
39	K5A RH 5.03X2.34X15	5.08±0.2	2.34±0.15	15±0.4		
40	K5A RH 5.08X2.29X10	5.08±0.2	2.29±0.15	10±0.4	40	65
41	K5A RH 6X2X25	6±0.2	2±0.15	25±0.6	135	200
42	K5A RH 6X2.2X30	6±0.2	2.2±0.15	30±0.7		
43	K5A RH 6X3.2X10	6±0.2	3.2±0.2	10±0.4		50
44	K5A RH 6X3X15	6±0.2	3±0.2	15±0.4		
45	K5A RH 6.35X2.95X25.4	6.35±0.2	2.95±0.15	25.4±0.6	108	200
46	K5A RH 6.35X3.2X12.7	6.35±0.2	3.2±0.2	12.7±0.4	55	102
47	K5A RH 6.4X3.2X10	6.4±0.2	3.2±0.2	10±0.4		50
48	K5A RH 6.5X4X10	6.5±0.2	4±0.2	10±0.4	20	40
49	K5A RH 6.5X4.3X10	6.5±0.25	4.3±0.2	10±0.4	20	45
50	K5A RH 6.5X4.5X10	6.5±0.2	4.5±0.2	10±0.4	15	35
51	K5A RH 6.78X4X14.22	6.78±0.2	4±0.2	14.22±0.4		
52	K5A RH 7.52X2.39X7.54	7.52±0.2	2.39±0.15	7.54±0.3	30	60

Changshu TianYin Non-Ferrous Metals Co., Ltd.

SLEEVE CORE

● Dimensions & Characteristics

Unit : mm

NO	ITEM	ØA	ØC	D	Impedance (Ω) min.	
					25MHz	100MHz
53	K5A RH 7.65X3.18X4.78	7.65±0.3	3.18±0.2	4.78±0.2	20	45
54	K5A RH 7.8X4X13	7.8±0.2	4±0.2	13±0.4	45	80
55	K5A RH 7.8X5X12.5	7.8±0.2	5±0.25	12.5±0.4	30	60
56	K5A RH 8X3.6X25	8±0.3	3.6±0.2	25±0.6	65	115
57	K5A RH 8X5.3X15	8±0.2	5.3±0.25	15±0.4	40	80
58	K5A RH 8X6X5	8±0.3	6±0.2	5±0.2	10	45
59	K5A RH 8.3X3.6X9.75	8.3±0.2	3.6±0.2	9.75±0.3		
60	K5A RH 8.7X6.3X15.7	8.7±0.2	6.3±0.3	15.7±0.4		80
61	K5A RH 9X5X16	9±0.3	5±0.25	16±0.4	50	80
62	K5A RH 9.05X5X16	9.05±0.3	4.7±0.2	16.2±0.4	60	110
63	K5A RH 9.3X4.5X9.5	9.3±0.3	4.5±0.2	9.5±0.3		
64	K5A RH 9.3X6.35X15.7	9.3±0.3	6.35±0.3	15.7±0.4		
65	K5A RH 9.5X3.05X10.2	9.5±0.3	3.05±0.2	10.2±0.4	50	90
66	K5A RH 9.5X4.7X25	9.5±0.4	4.7±0.2	27±0.6	73	135
67	K5A RH 9.5X5.5X19.5	9.5±0.2	5.5±0.3	19.5±0.6	50	100
68	K5 RH 9.5X4.75X19.05	9.5±0.3	4.75±0.2	19.05±0.4	60	100
69	K5A RH 9.5X4.75X25.4	9.5±0.3	4.75±0.2	25.4±0.6	75	135
70	K5A RH 9.5X4.8X14.5	9.5±0.3	4.8±0.2	14.5±0.4	53	75
71	K5A RH 9.5X5X14.5	9.5±0.3	5±0.25	14.5±0.4	50	100
72	K5A RH 9.5X5.2X9.5	9.5±0.3	5.2±0.25	9.5±0.4	35	65
73	K5A RH 9.65X5.02X10.4	9.65±0.3	5.02±0.25	10.4±0.4	30	60
74	K5A RH 9.7X3.8X10.2	9.7±0.3	3.8±0.2	10.2±0.4	60	100
75	K5A RH 9.8X1X11.5	9.8±0.2	1±0.15	11.5±0.3	120	200
76	K5A RH 9.8X6.3X15.7	9.8±0.3	6.35±0.3	15.7±0.4	45	65
77	K5A RH 9.8X6.35X13.5	9.8±0.3	6.35±0.25	13.5±0.4	30	60
78	K5A RH 10X4.25X19.5	10±0.35	4.25±0.3	19.5±0.5	80	120
79	K5A RH 10X5X25	10±0.3	5±0.25	25±0.6	125	160
80	K5A RH 10X5.5X25	10±0.3	5.5±0.25	25±0.6	90	160
81	K5A RH 10X6X14	10±0.3	6±0.3	14±0.4	35	75
82	K5A RH 10X6.15X6.2	10±0.3	6.15±0.3	6.2±0.3	45	85
83	K5A RH 10X6.5X20	10±0.4	6.5±0.25	20±0.6	40	90
84	K5A RH 10X7X10	10±0.3	7±0.3	10±0.4	20	40
85	K5A RH 10X7.3X7.5	10±0.3	7.3±0.2	7.5±0.2	13	28
86	K5A RH 10.5X5.5X20	10.5±0.3	5.5±0.25	20±0.5	65	120
87	K5A RH 10.5X6X20	10±0.4	6±0.3	20±0.6	50	90
88	K5A RH 10.5X6.5X20	10.5±0.3	6.5±0.3	20±0.5	40	80
89	K5A RH 11X5X25	11±0.3	5±0.25	25±0.6	115	180
90	K5A RH 11.3X5.95X12	11.3±0.3	5.95±0.25	12±0.4	40	70
91	K5A RH 11.5X4.9X20	11.5±0.5	4.9±0.25	20±0.6	100	200
92	K5A RH 11.5X4.9X25	11.5±0.3	4.9±0.25	25±0.5	85	120
93	K5A RH 11.8X5X15	11.8±0.3	5±0.3	15±0.4	40	80
94	K5A RH 11.8X7.3X15	11.8±0.3	7.3±0.3	15±0.4	40	75

Changshu TianYin Non-Ferrous Metals Co., Ltd.

SLEEVE CORE

● Dimensions & Characteristics

Unit : mm

NO	ITEM	ØA	ØC	D	Impedance (Ω) min.	
					25MHz	100MHz
95	K5A RH 11.86X7.4X15	11.86±0.3	7.4±0.3	15±0.4	35	75
96	K5A RH 12X3.7X19.2	12±0.3	3.7±0.2	19.2±0.6	60	120
97	K5A RH 12X3.7X23.5	12±0.3	3.7±0.2	23.5±0.6	95	160
98	K5A RH 12X4X23	12±0.3	4±0.2	23±0.5	160	230
99	K5A RH 12X4.5X25	12±0.3	4.5±0.2	25±0.4	125	204
100	K5A RH 12X5.6X20	12±0.3	5.6±0.25	20±0.5	100	200
101	K5A RH 12X5.6X25	12±0.4	5.6±0.3	25±0.6	80	120
102	K5A RH 12X6X20	12±0.3	6±0.3	20±0.5	60	110
103	K5A RH 12X8X13	12±0.3	8±0.3	13±0.4	35	75
104	K5A RH 12X8X22.8	12±0.3	8±0.25	22.8±0.6	40	80
105	K5A RH 12X8.5X15	12±0.3	8.5±0.3	15±0.4	30	50
106	K5 RH 12X8.5X20	12±0.3	8.5±0.2	20±0.4	30	60
107	K5A RH 12.3X5X12.7	12.3±0.3	5±0.25	12.7±0.4	60	120
108	K5A RH 12.7X7.9X12.7	12.7±0.3	7.9±0.3	12.7±0.4	30	60
109	K5A RH 13X5X18	13±0.3	5±0.25	18±0.5	50	100
110	K5A RH 13X5X20	13±0.3	5±0.25	20±0.5	90	140
111	P3 RH 13X7X15	13±0.3	7±0.3	15±0.4	75	140
112	K5A RH 13X7.3X12.7	13±0.4	7.3±0.2	12.7±0.4	30	60
113	K5 RH 13X8.5X25	13±0.3	8.5±0.2	25±0.6	40	80
114	K5A RH 14X6.8X15	14±0.4	6.8±0.3	15±0.4	65	120
115	K5A RH 14X7.8X15	14±0.4	7.8±0.3	15±0.4	35	70
116	K5A RH 14.2X4.5X20	14.2±0.4	4.5±0.3	20±0.5	100	170
117	K5A RH 14.2X4.5X28.5	14.2±0.4	4.5±0.3	28.5±0.8	120	280
118	K5A RH 14.2X6.35X28.5	14.2±0.4	6.35±0.6	28.5±0.6	100	190
119	K5A RH 14.2X6.35X36	14.2±0.4	6.35±0.6	36±0.8	150	280
120	K5A RH 14.2X6.5X15	14.2±0.4	6.5±0.3	15±0.4	50	90
121	K5A RH 14.2X7.2X28.5	14.2±0.4	7.2±0.3	28.5±0.6	130	210
122	K5A RH 14.2X7X28.5	14.2±0.4	7±0.3	28.5±0.6	100	120
123	K5A RH 14.2X7.2X12.7	14.2±0.3	7.2±0.3	12.7±0.4	40	60
124	K5A RH 14.2X8X23.5	14.2±0.4	8±0.3	23.5±0.5	65	135
125	K5A RH 14.2X8X28.5	14.2±0.4	8±0.3	28.5±0.6	60	150
126	K5A RH 14.2X9.15X28.5	14.2±0.4	9.15±0.3	28.5±0.6	100	170
127	K5A RH 14.2X9X15	14.2±0.4	9±0.3	15±0.4	50	100
128	K5A RH 14.3X6.35X23.3	14.3±0.4	6.35±0.3	23.3±0.5	100	180
129	K5A RH 14.3X9.15X28.5	14.3±0.4	9.15±0.3	28.5±0.6	75	120
130	K5A RH 14.3X9X28.5	14.3±0.4	9±0.3	28.5±0.6	75	120
131	K5A RH 14.5X10.5X8	14.5±0.4	10±0.4	8±0.3	18	45
132	K5A RH 15.7X10.5X28.5	15.7±0.4	10.5±0.3	28.5±0.6	60	100
133	K5A RH 15.7X7.3X28.5	15.7±0.4	7.3±0.3	28.5±0.6	90	180
134	K5A RH 15.7X7.5X28.5	15.7±0.4	7.5±0.3	28.5±0.6	90	180
135	K5A RH 15.88X8X28.5	15.88±0.4	8±0.3	28.5±0.6	100	160
136	K5A R3H 16X5X28	16±0.4	5±0.3	28±0.8	90	160

Changshu TianYin Non-Ferrous Metals Co., Ltd.

SLEEVE CORE

● Dimensions & Characteristics

Unit : mm

NO	ITEM	ØA	ØC	D	Impedance (Ω) min.	
					25MHz	100MHz
137	K5A RH 16X8X16	16±0.4	8±0.3	16±0.4	55	110
138	K5A RH 16X9X17	16±0.4	9±0.3	17±0.4	50	80
139	K5A RH 16X9X28	16±0.4	9±0.3	28±0.6	80	150
140	K5A RH 16X10.5X28	16±0.4	10.5±0.3	28±0.6		100
141	K5A RH 17.07X8.76X25.4	17.07±0.4	8.76±0.3	25.4±0.6	90	130
142	K5A RH 17.2X7X28.5	17.2±0.4	7±0.3	28.5±0.6	140	230
143	K5A RH 17.2X7.1X28	17.2±0.4	7.1±0.3	28±0.8	120	180
144	P2M RH 17.5X7X25.4	17.5±0.4	7±0.3	25.4±0.6	110	200
145	K5A RH 17.5X9.5X12.7	17.5±0.5	9.5±0.3	12.7±0.4	50	150
146	K5A RH 17.5X9.5X28.5	17.5±0.4	9.5±0.3	28.5±0.6	85	145
147	K5A RH 17.5X9.5X35	17.5±0.4	9.5±0.3	35±0.8	120	200
148	K5A RH 17.5X10.5X24	17.5±0.4	10.5±0.4	24±0.6	85	130
149	K5A RH 17.5X10.5X28.5	17.5±0.4	10.5±0.4	28.5±0.6	60	120
150	K5A RH 17.5X10X28.5	17.5±0.4	10±0.4	28.5±0.6	100	240
151	K5A RH 17.5X11X28.5	17.5±0.4	11±0.4	28.5±0.6	80	130
152	K5A RH 17.5X11.5X28.5	17.5±0.5	11.5±0.2/-0.6	28.5±0.8	60	110
153	K5A RH 17.5X12.8X28.5	17.5±0.5	12.8±0.4	28.5±0.8	40	80
154	K5A RH 18X10.5X18	18±0.5	10.5±0.3	18±0.5	45	90
155	K5A RH 18.2X9.7X28.2	18.2±0.5	9.7±0.3	28.2±0.6	104	192
156	K5A RH 18.4X9.6X12	18.4±0.4	9.6±0.3	12±0.4	40	60
157	K5A RH 18.5X12.6X28.5	18.5±0.5	12.6±0.5	28.5±0.6	50	80
158	K5A RH 18.7X10.2X28.2	18.7±0.5	10.2±0.4	28.2±0.6	70	130
159	K5A R3H 19X6X28	19±0.4	6±0.3	28±0.8	90	160
160	K5A RH 19X10X10	19±0.4	10±0.3	10±0.3	39	73
161	K5A RH 19X13X29	19±0.5	13±0.4	29±0.6	60	110
162	K5A RH 19.2X11.6X28.6	19.2±0.5	11.6±0.4	28.6±0.6	76	118
163	K5A RH 20X10X28	20±0.5	10±0.3	28±0.8	95	150
164	K5A RH 20.7X12X28.5	20.7±0.6	12±0.4	28.5±0.6	85	160
165	K5A RH 21X10X30	21±0.5	10±0.4	30±0.8	100	150
166	K5A RH 22X14X28	22±0.6	14±0.5	28±0.8	60	120
167	K5A RH 25.9X12.3X29	25.9±0.6	12.3±0.4	29±0.6	90	180
168	K5A RH 25.9X12.7X29	25.9±0.6	12.7±0.4	29±0.6	120	240
169	K5A RH 26X13X28.5	26±0.6	13±0.4	28.5±0.6	116	180
170	K5A RH 26X14X28.5	26±0.6	14±0.4	28.5±0.6	90	180
171	K5A RH 27X10X30	27±0.5	10±0.3	30±0.9	95	150
172	K5A RH 28X14X28	28±0.6	14±0.4	28±0.6	110	180
173	K5A RH 28X16X28.5	28±0.6	16±0.4	28.5±0.6	110	220
174	K5A RH 28X18X28.5	28±0.6	18±0.4	28.5±0.6	75	140