

**MODALITA' DI MONTAGGIO / HOW TO ASSEMBLE**

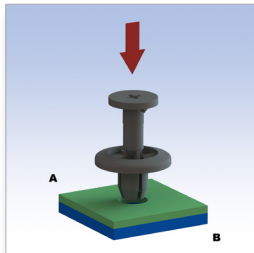

**Centrare e inserire il rivetto nel foro.**  
*Centre and insert the rivet into the hole.*

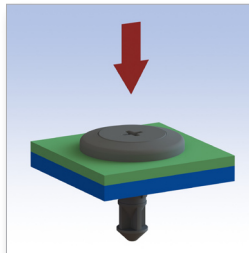

**Spingere il perno con un martello morbido fino in fondo.**  
*Push the rivet with a soft hammer right to the bottom.*

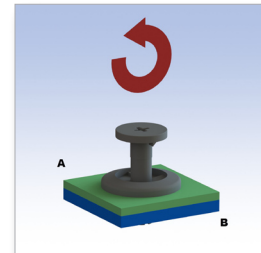

**Per lo smontaggio ruotare la testa di 90°.**  
*Quarter turn to realise.*

■ **Materiale: POM / Material: POM**

■ **Autoestinguenza: HB (UL94) / UL Flammability: HB (UL94)**

■ **Tutte le quote sono in mm. / All dimensions are in mm.**

■ **Colore: Nero / Colour: Black**

CODICE P/N	DIMENSIONI SIZES			PANNELLO PANEL		NOTE NOTES	CONF. PKG.
	A	H	L	foro/hole	Sp./Th.		
<b>8095 GA01</b>	17,9	2,3	16,2	Ø 6,0	3,0 - 5,0		1.000
<b>8096 GA01</b>	16,0	2,3	14,2	Ø 7,0	2,5 - 5,0		1.000
<b>8097 GA01</b>	19,9	2,9	18,3	Ø 8,0	3,5 - 6,0		1.000
<b>8098 GA01</b>	18,7	3,6	25,4	Ø 9,0	4,0 - 7,5		1.000