

Tipo 1 Type 1

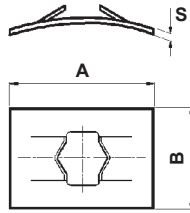

Tipo 2 Type 2



Tipo 2A Type 2A

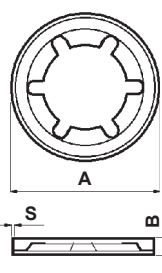

Tipo 2B Type 2B

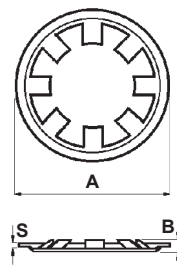

Tipo 2C Type 2C

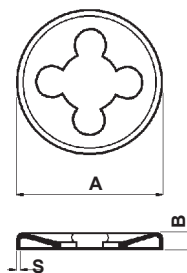

Applicazione
Assembly

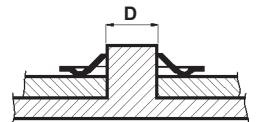

■ Materiale: Acciaio temprato / Hardened Steel

■ Tutte le quote sono in mm. / All dimensions are in mm.

CODICE P/N	TIPO TYPE	DIMENSIONI SIZES			D Perno/pin	NOTE NOTES	CONF. PKG.
		A	B	S			
1514 MC90	1	13	8	0,35	3		pz. 1 pcs. 5.000
3683 MC90	1	15	8	0,4	3,5		5.000
1530 MC90	2A	5,5	0,9	0,3	2,4		5.000
1531 MC90	2A	9,5	1,7	0,4	3		5.000
1532 MC90	2A	7,1	1,35	0,3	3,1		5.000
1534 MC90	2A	11,5	1,5	0,3	4		5.000
5491 MC90	2B	26,3	2,5	0,4	14,4		5.000
5492 MC90	2B	26,3	2,5	0,4	14,8		5.000
5493 MC90	2B	26,3	1,9	0,4	15,5		5.000
2329 MC90	2B	26,2	2	0,4	16		5.000
0905 MC90	2C	11,4	1,1	0,25	5		10.000